

NOTE:
20mm H3.1 horizontal cavity battens at maximum 800crs with 15 deg slope to top edge and separation layer over

Vertically fixed Euro-line / Euro-lap powder coated aluminium cladding installed by Flashclad Nationwide Distributor Network

NOTE:
Euro-line / Euro-lap Vertical can be fixed to dwang lines at **600mm or 800mm** centres
Type 17 stainless steel 65mm roofing screws

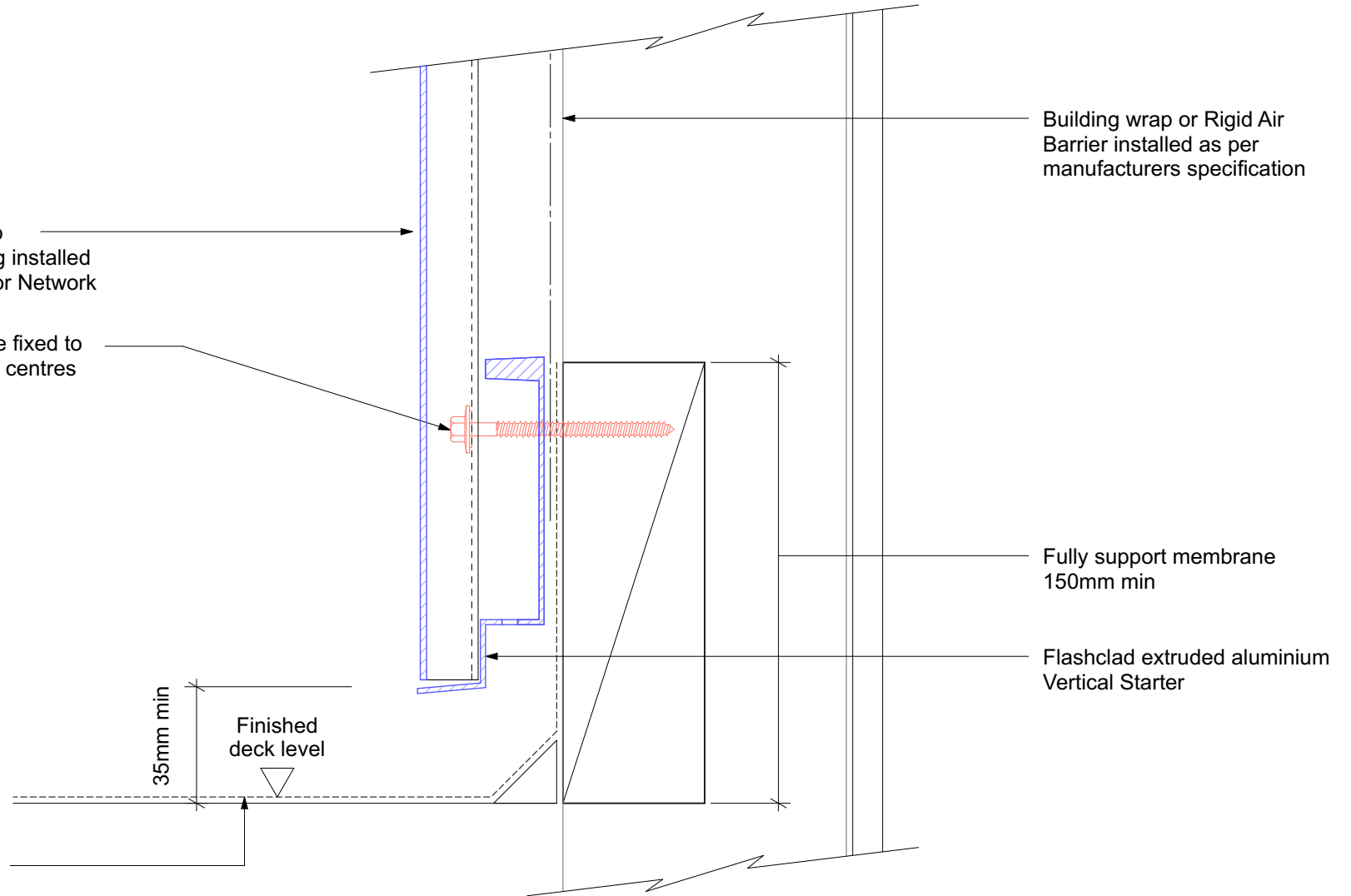

Flashclad
CLADDING FOR LIFE

ENCLOSED BALCONY BASE

Original Scale 1:2

Revision - 01 October 2019

Eurobord
VERTICAL