

NOTE:
20mm H3.1 horizontal cavity battens at maximum 800crs with 15 deg slope to top edge and separation layer over

Vertically fixed Euro-line / Euro-lap powder coated aluminium cladding installed by Flashclad Nationwide Distributor Network

NOTE:
Euro-line / Euro-lap Vertical can be fixed to dwang lines at **600mm or 800mm** centres
Type 17 stainless steel 65mm roofing screws

Flashclad extruded aluminium Vertical Starter

width as per NZBC E2/AS1
Table 7
35mm minimum gap

Building wrap or Rigid Air Barrier installed as per manufacturers specification
Flashing tape or extra layer of building wrap over flashing
Hem to purpose made perpendicular apron flashing
75mm minimum cover

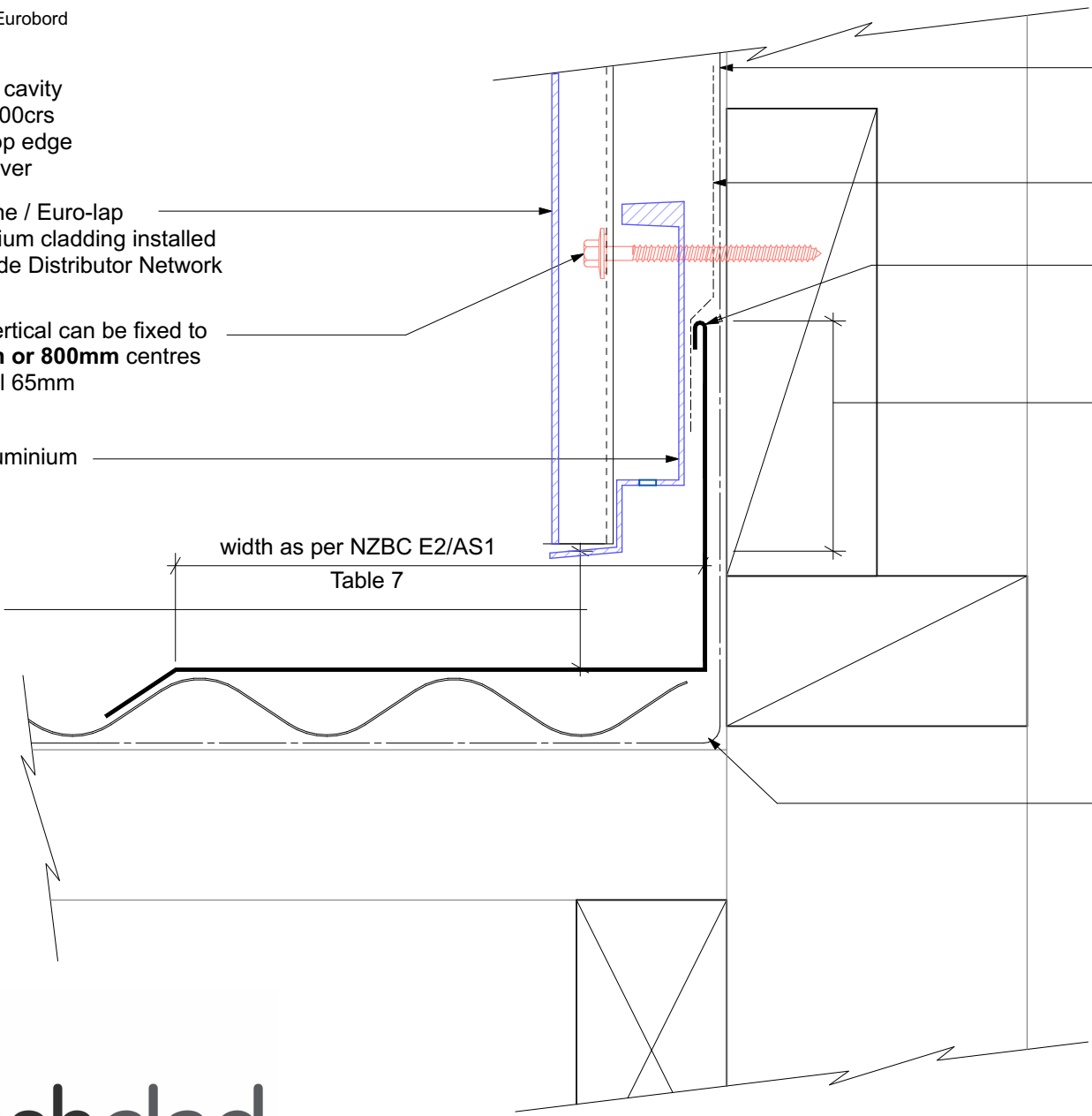

RAKING APRON DETAIL
Original Scale 1:2
Revision - 01 October 2019

Eurobord
VERTICAL