

Horizontally fixed Euro-line / Euro-lap powder coated aluminium cladding installed by Flashclad Nationwide Distributor Network

NOTE:  
Fixing into studs at maximum 600mm centres.  
Type 17 stainless steel 65mm roofing screws.

20mm H3.1 vertical cavity batten with separation layer over

Deck membrane on structure

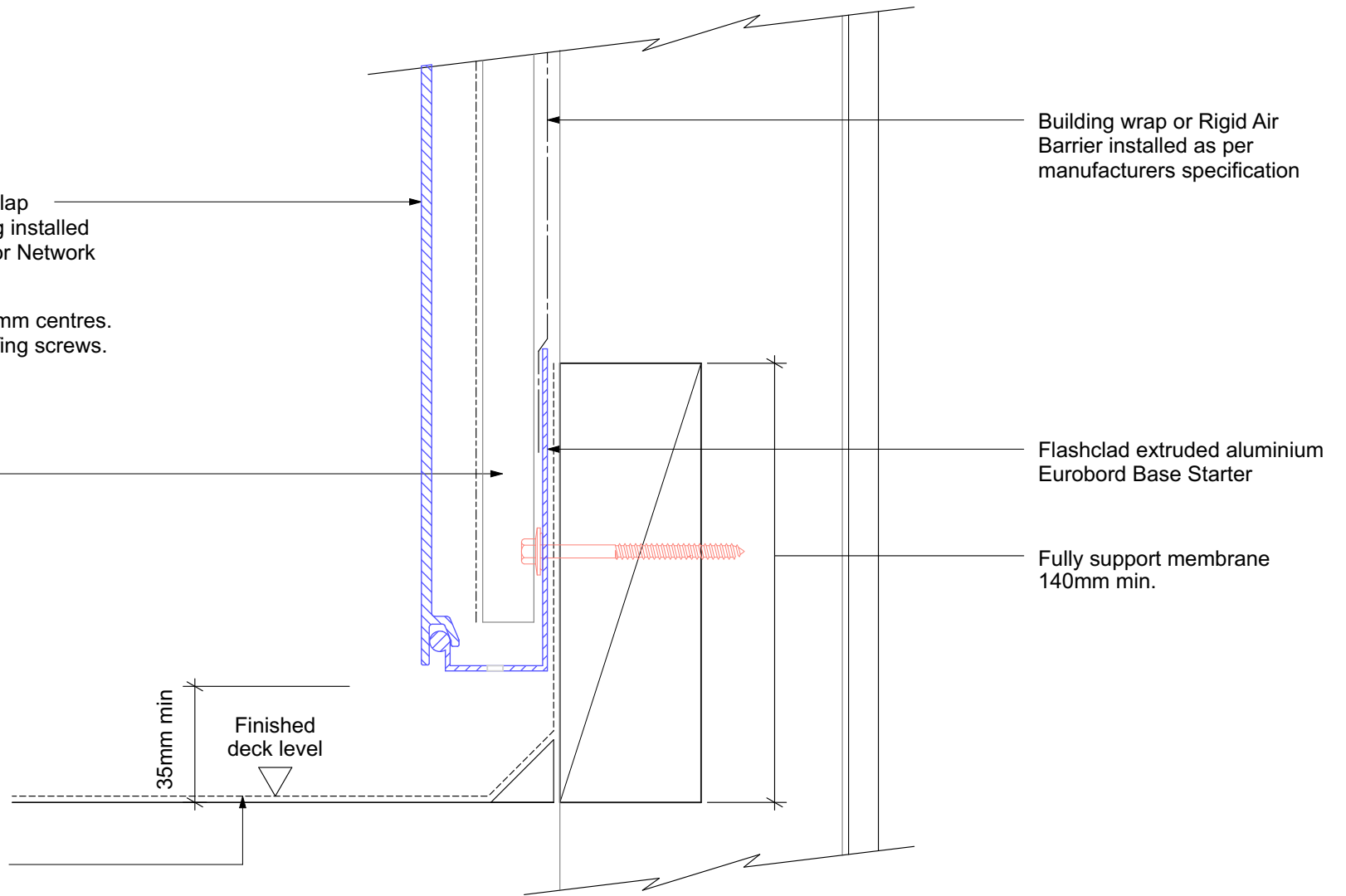

Building wrap or Rigid Air Barrier installed as per manufacturers specification

Flashclad extruded aluminium Eurobord Base Starter

Fully support membrane 140mm min.