

Vertically fixed Dualbord extruded aluminium cladding installed by Flashclad Nationwide Distributor Network

**NOTE:**

Dualbord Vertical can be fixed to dwang lines at **600mm or 800mm** centres.  
Type 17 stainless steel 65mm roofing screws.

20mm H3.1 horizontal cavity battens at maximum 800crs with 15 deg slope to top edge and separation layer over

Flashclad extruded aluminium Vertical Starter

35mm minimum gap

length as per NZBC E2/AS1  
Table 7

Building wrap or Rigid Air Barrier installed as per manufacturers specification

Flashing tape or extra layer of building wrap over flashing

Hem to purpose made perpendicular apron flashing

75mm minimum cover

Roofing underlay to continue up behind flashing

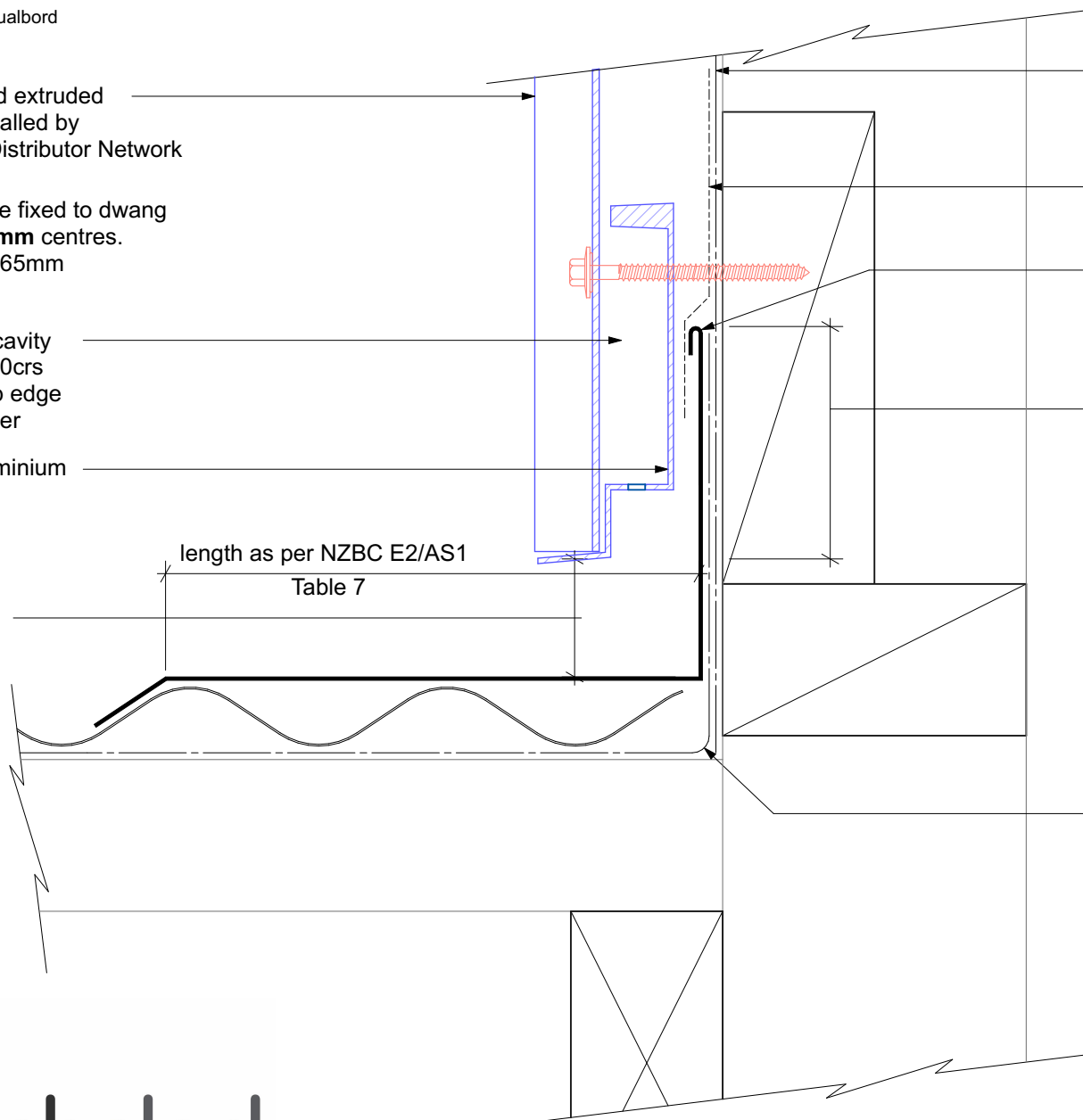

**Flashclad**  
CLADDING FOR LIFE

**RAKING APRON DETAIL**

Original Scale 1:2  
Revision - 01 October 2019

**Dualbord**  
VERTICAL