

20mm H3.1 horizontal cavity battens at maximum 800crs with 15 deg slope to top edge and separation layer over

Flashclad extruded aluminium Internal Corner with Locators

Vertically fixed Dualbord extruded aluminium cladding installed by Flashclad Nationwide Distributor Network

NOTE:
Dualbord Vertical can be fixed to dwang lines at **600mm or 800mm** centres.
Type 17 stainless steel 65mm roofing screws.

H3.1 200mm long packers

Building wrap or Rigid Air Barrier installed as per manufacturers specification

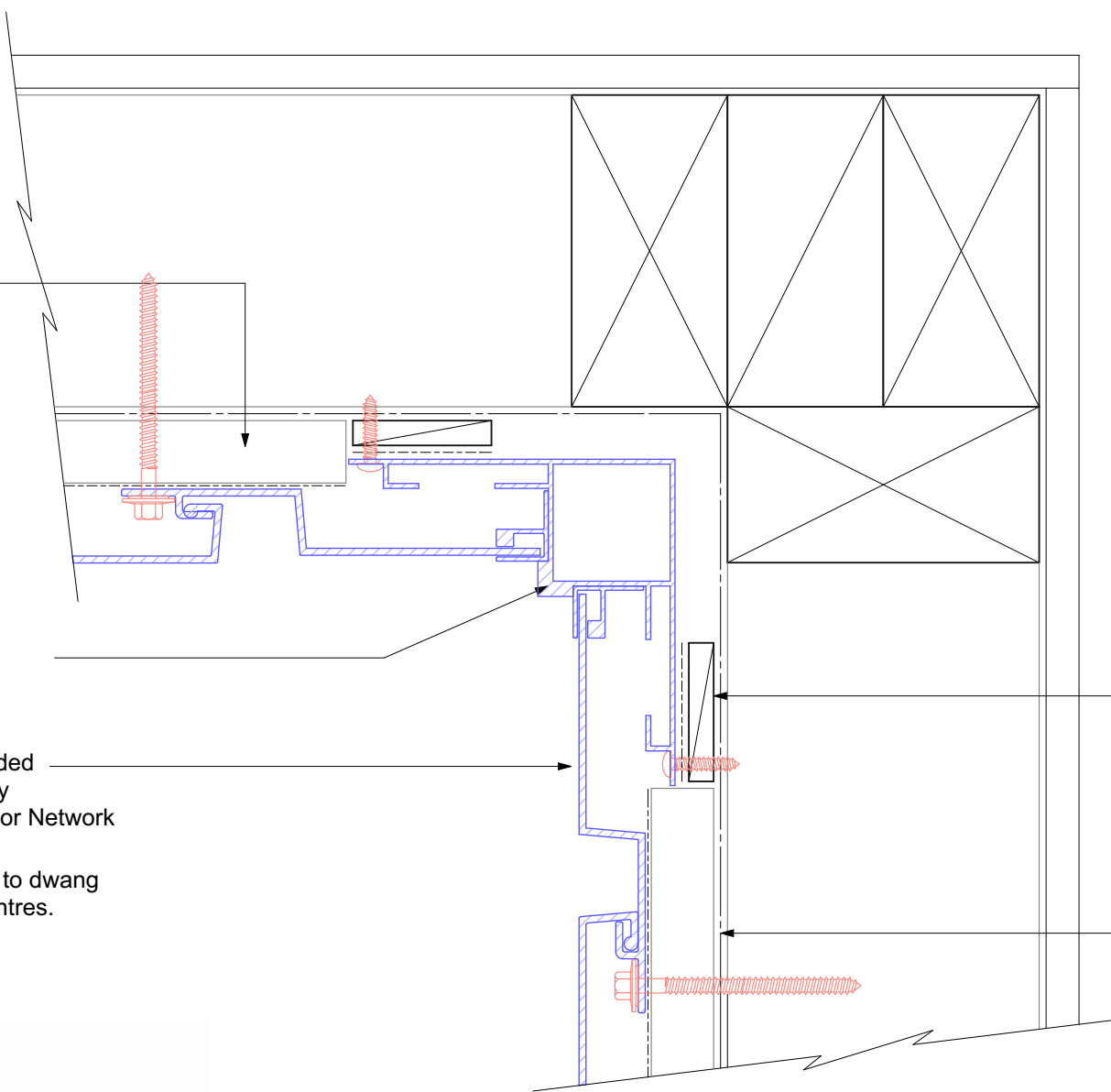

Flashclad
CLADDING FOR LIFE

INTERNAL CORNER

Original Scale 1:2

Revision - 01 October 2019

Dualbord

VERTICAL