

Vertically fixed Dualbord extruded aluminium cladding installed by Flashclad Nationwide Distributor Network

NOTE:

Dualbord Vertical can be fixed to dwang lines at **600mm or 800mm** centres. Type 17 stainless steel 65mm roofing screws.

Building wrap or Rigid Air Barrier installed as per manufacturers specification

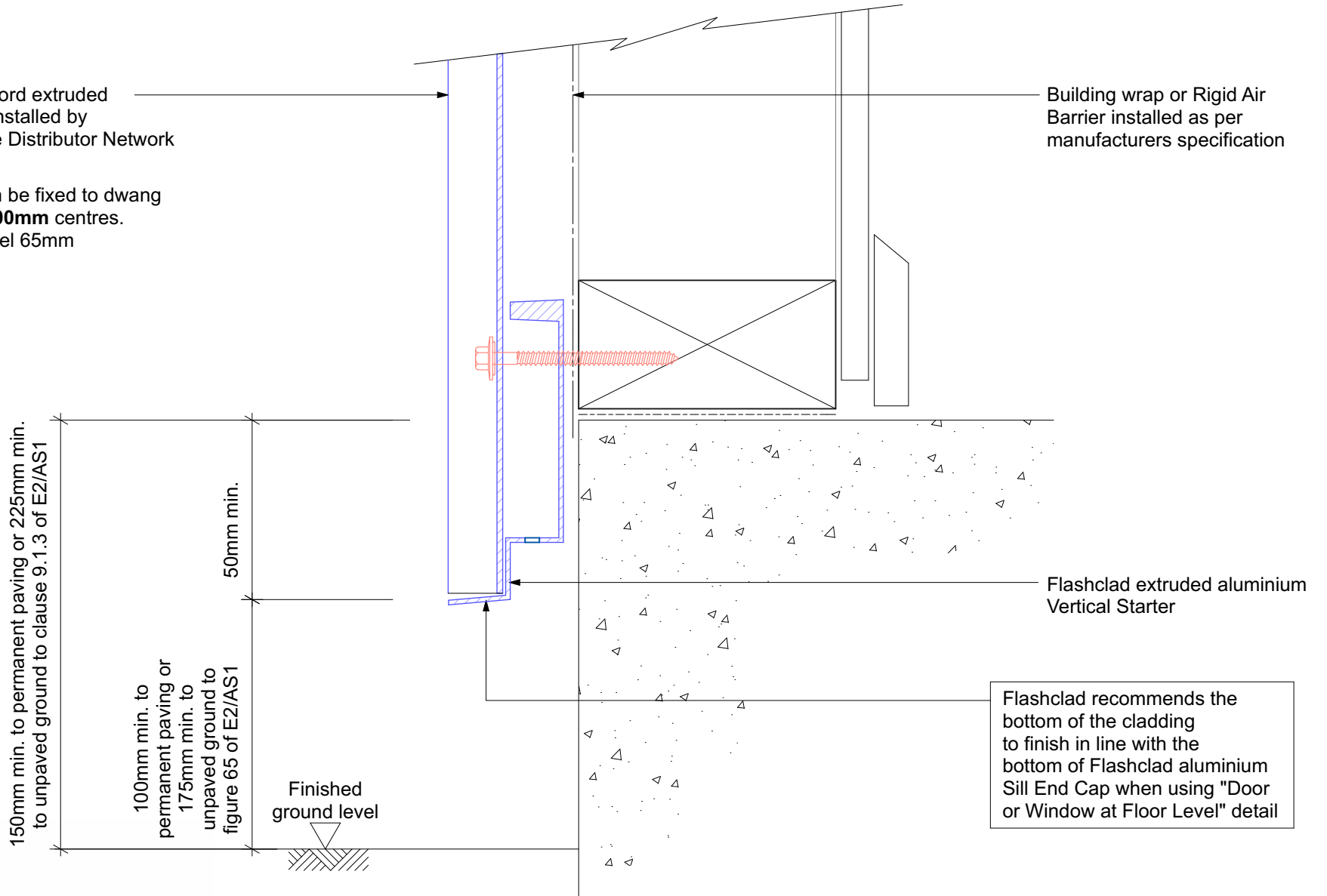

Flashclad
CLADDING FOR LIFE

**BASE STARTER AND
CAVITY CLOSURE**

Original Scale 1:2

Revision - 01 October 2019

Dualbord
VERTICAL