

Flashclad extruded aluminium
2 Part Jamb

Flashclad extruded aluminium
Locator

20mm H3.1 vertical cavity batten
with separation layer over

Horizontally fixed Dualbord extruded
aluminium cladding installed by
Flashclad Nationwide Distributor Network

NOTE:
Fixing into studs at maximum
600mm centres.
Type 17 stainless steel 65mm
roofing screws.

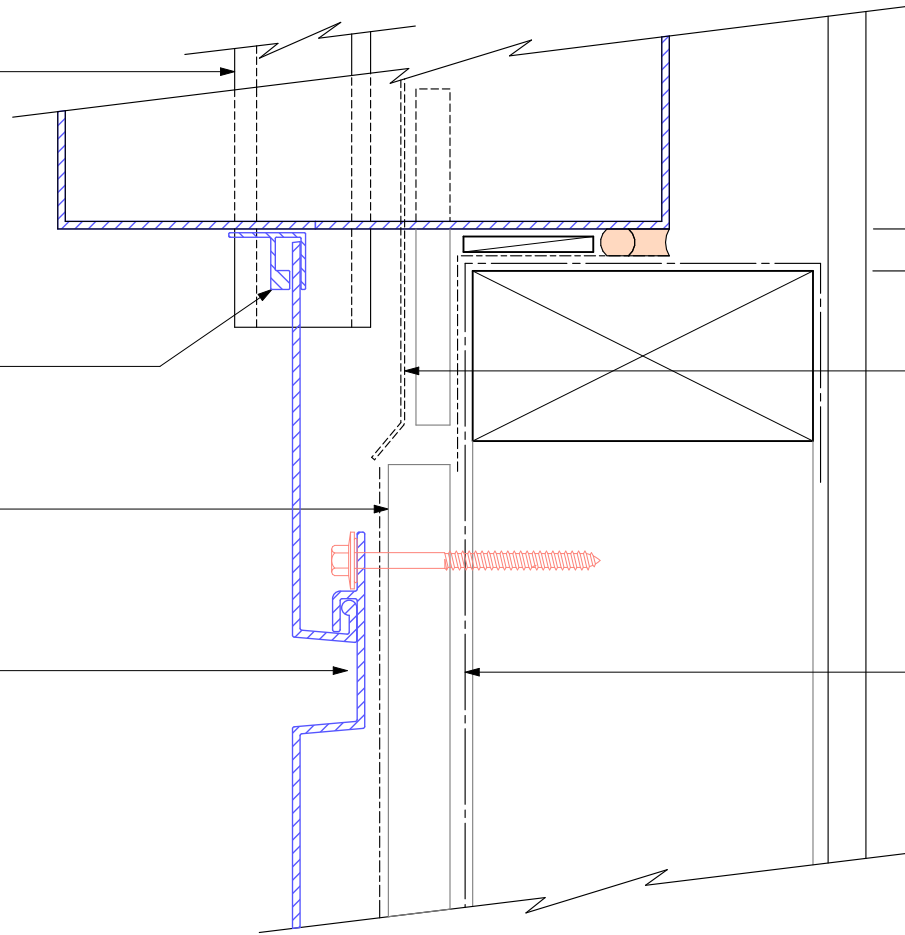

Flashclad Back Plate pack
to behind jamb flashing and
cut to fit around base of
meter box (shown dashed)

Building wrap or Rigid Air
Barrier installed as per
manufacturers specification

NOTE:
Meter box installed with
flashing tape and air seal over
PEF backing rod as per
NZBC E2/AS1



METER BOX BASE
Original Scale 1:2
Revision - 01 October 2019

Dualbord
HORIZONTAL