

Selected Flashclad extruded aluminium cladding installed by Flashclad Nationwide Distributor Network

NOTE:
Fixing into studs at maximum 600mm max centres for horizontal cladding
800mm max centres for vertical cladding

Fix junction into dwangs and top and bottom plates

Flashclad extruded aluminium Cladding Junction Flashing

10mm min cover

Attach flashing to suit 40mm cavity

EXAMPLE
AAC Panel and coating installed as per manufacturers specification.
20 and 40mm cavity shown

NOTE:
This detail can be modified to suit most cladding types and cavity depths

Building wrap or Rigid Air Barrier installed as per manufacturers specification

Rivet cladding to junction

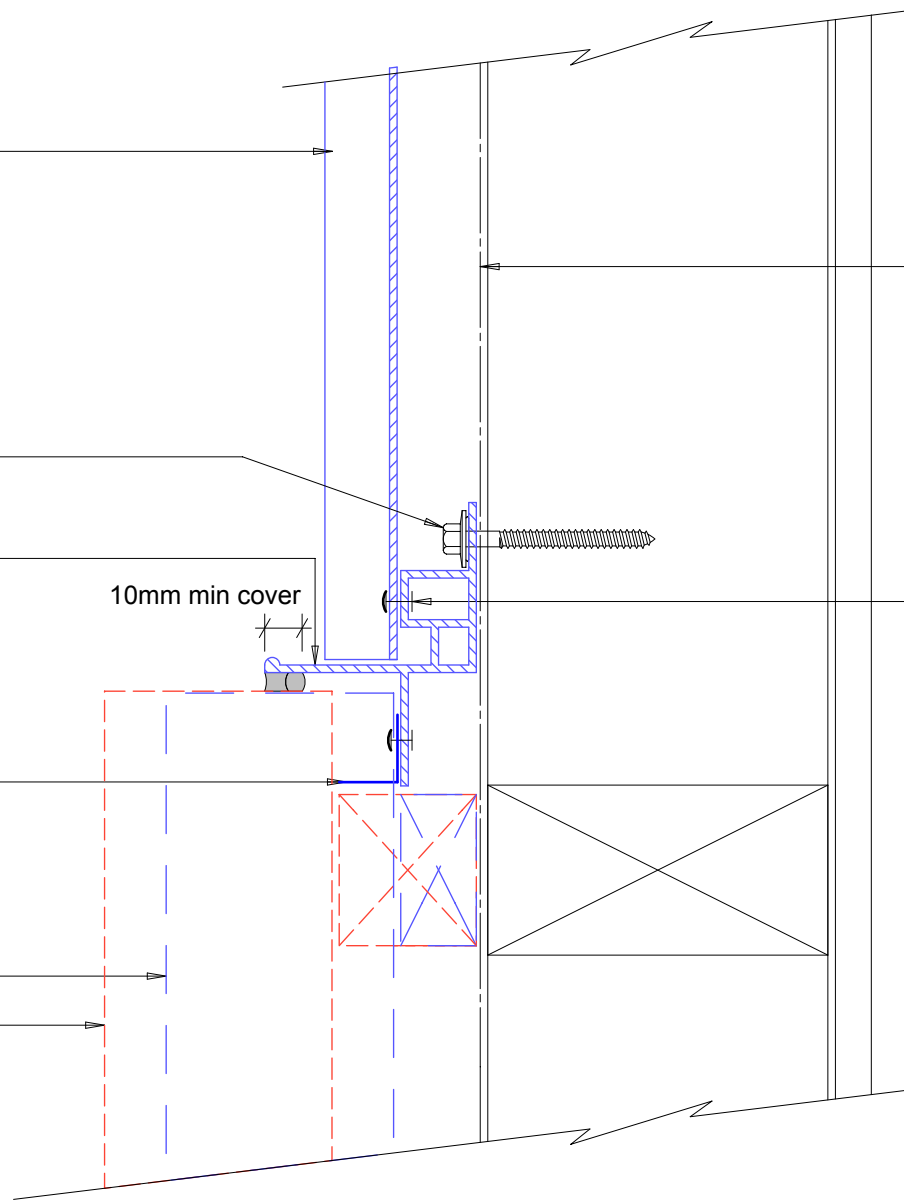

WALL PLANE CLADDING JUNCTION

Original Scale 1:2
Revision - 25 July 2017

(EXAMPLE)