

Selected Flashclad extruded aluminium cladding installed by Flashclad Nationwide Distributor Network

20mm H3.1 vertical cavity batten with separation layer over

H3.1 12mm thick 200mm long plywood packers

Flashclad extruded aluminium External Corner

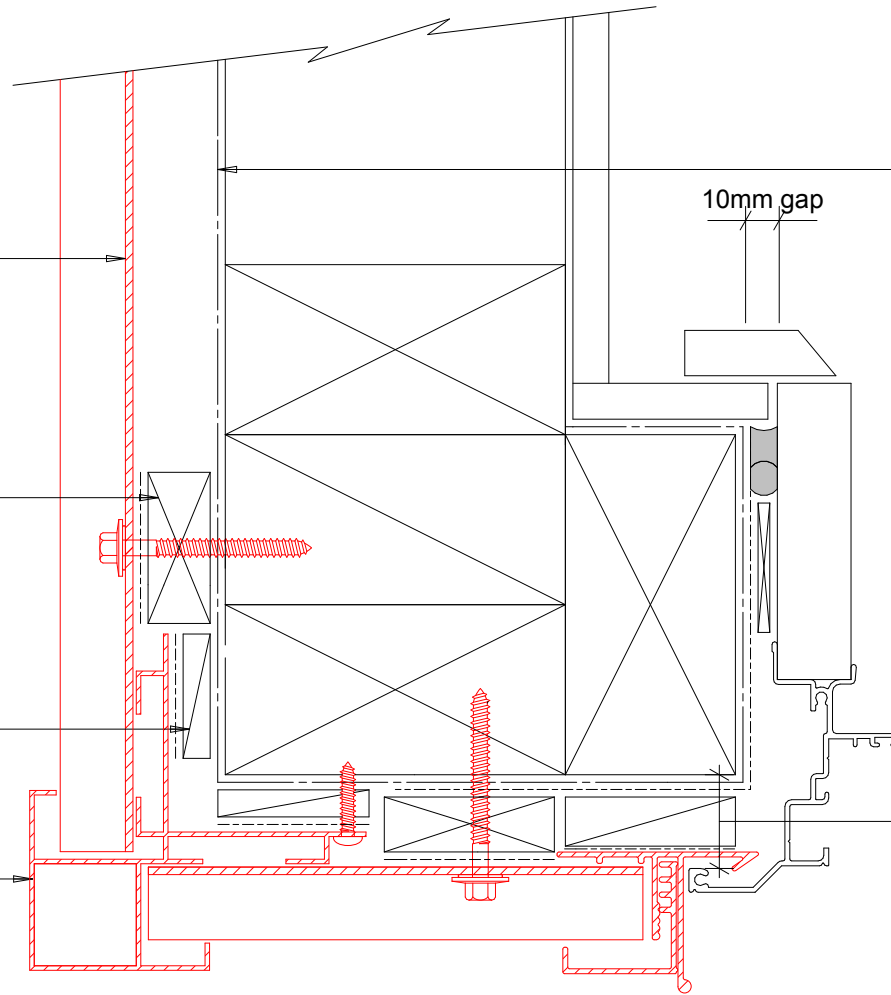

10mm gap

Building wrap or Rigid Air Barrier installed as per manufacturers specification

NOTE:
Aluminium joinery installed with flashing tape and air seal over PEF backing rod as per NZBC E2/AS1

25mm from the outside face of the framing (for building wrap detailing) or 25mm from the outside face of the Rigid Air Barrier to the back of the aluminium angle



Flashclad
CLADDING FOR LIFE

EXTERNAL CORNER JOINERY CLEARANCES

Original Scale 1:2

Revision - 11 February 2016