

NOTE:
20mm H3.1 horizontal cavity
battens at maximum 800crs
with 15 deg slope to top edge
and separation layer over

Vertically fixed Eurobord extruded
aluminium cladding installed by
Flashclad Nationwide Distributor Network

NOTE:
Eurobord Vertical can be fixed to dwang
lines at **600mm or 800mm** centres

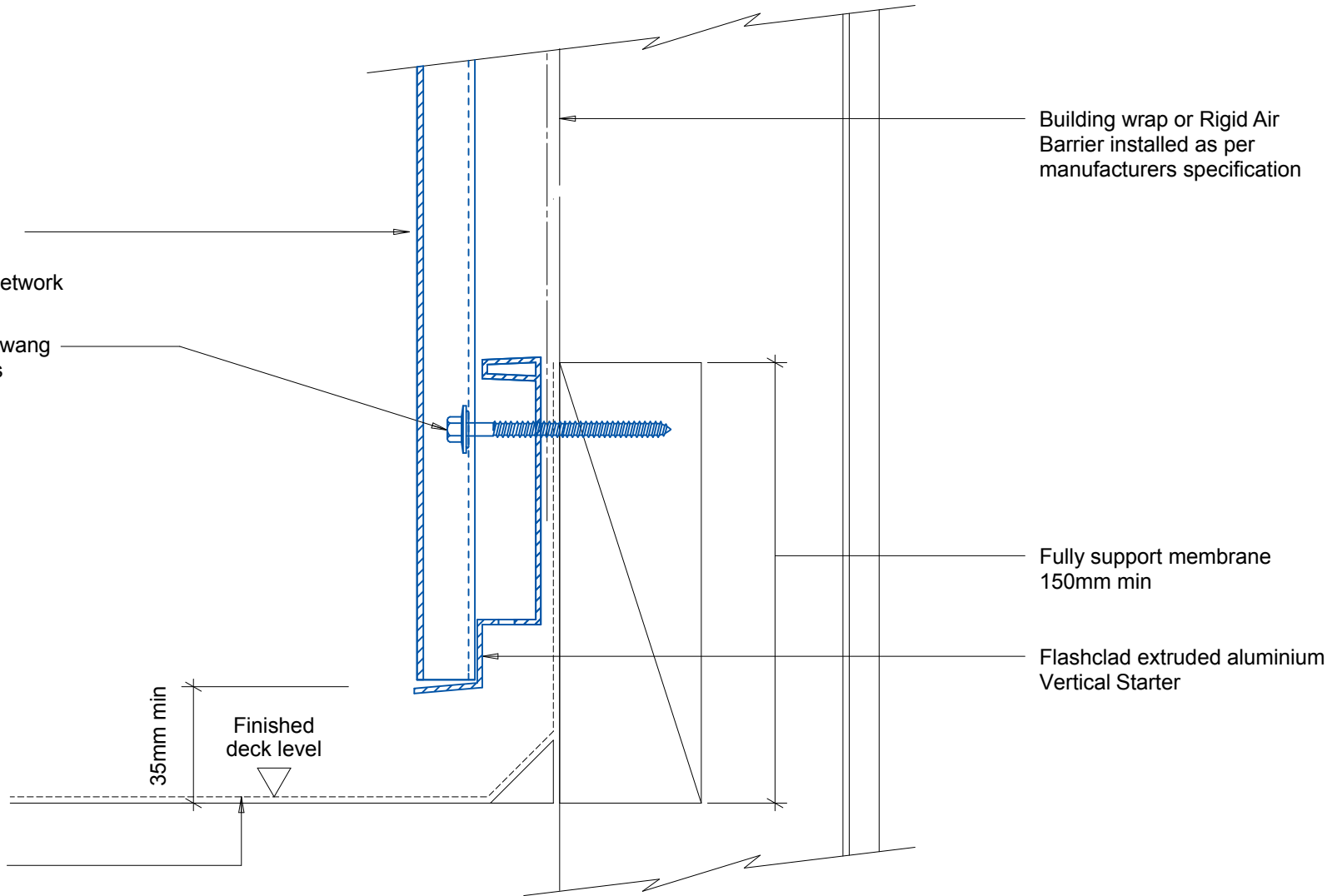

Flashclad
CLADDING FOR LIFE

ENCLOSED BALCONY BASE

Original Scale 1:2
Revision - 20 October 2015

Eurobord
VERTICAL