

20mm H3.1 vertical cavity batten with separation layer over

Horizontally fixed Eurobord extruded aluminium cladding installed by Flashclad Nationwide Distributor Network

NOTE:
Fixing into studs at maximum 600mm centres

Flashclad extruded aluminium Cavity Starter

Flashclad extruded aluminium Cover Mould

Flashclad extruded aluminium Locator

width as per NZBC E2/AS1
Table 7

35mm minimum gap

Building wrap or Rigid Air Barrier installed as per manufacturers specification

Flashing tape or extra layer of building wrap over flashing

Hem to purpose made perpendicular apron flashing

75mm minimum cover

Roofing underlay to continue up behind flashing

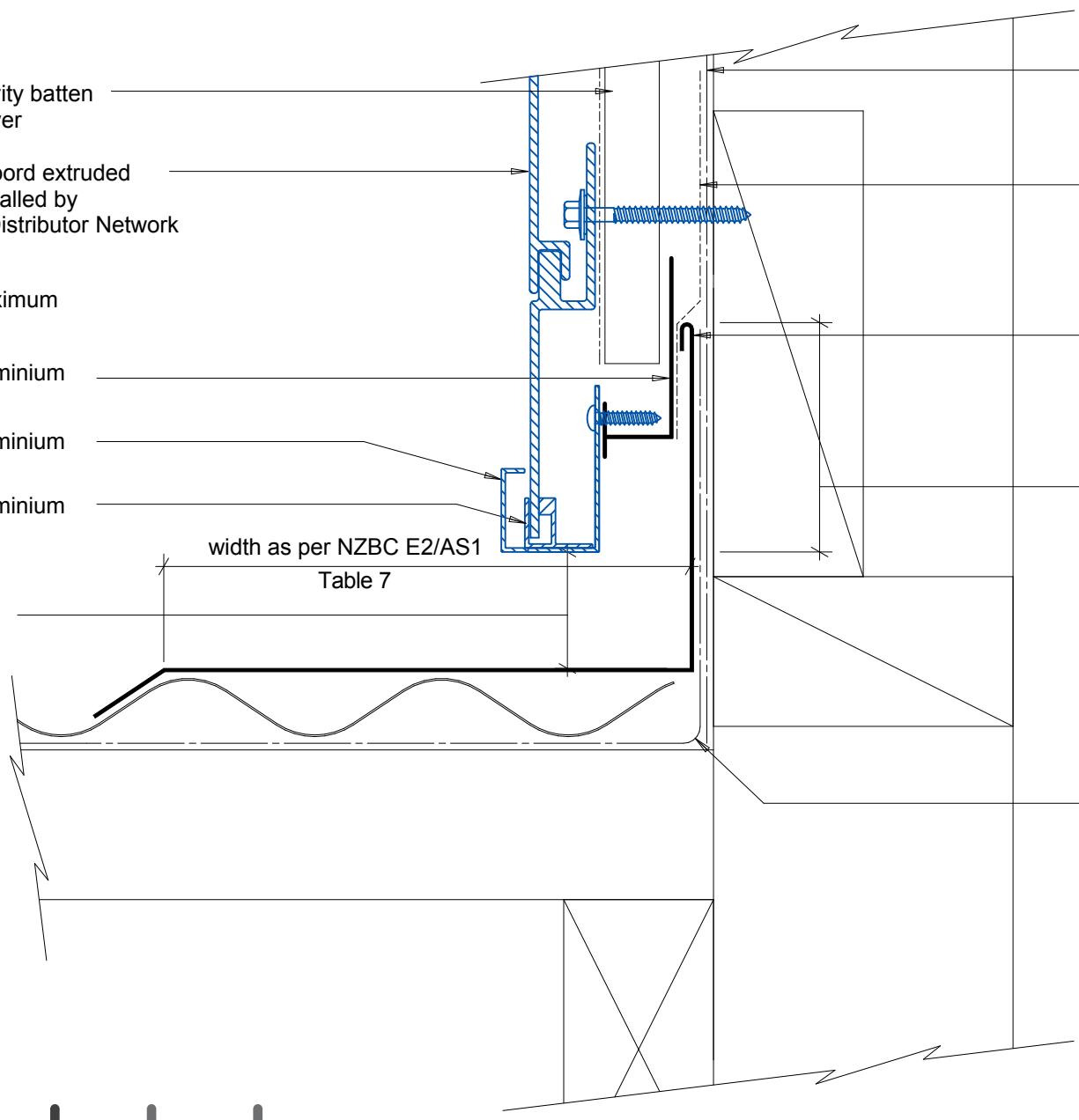

Flashclad
CLADDING FOR LIFE

RAKING APRON DETAIL

Original Scale 1:2
Revision - 20 October 2015

Eurobord

HORIZONTAL