

Flashclad extruded aluminium
2 Part Jamb

3mm gap between bottom edge
of the cladding and the top of the
Flashclad Sill

Flashclad extruded aluminium
Slimline Sill with End Cap
(shown dashed)

NOTE:
Sill provides full joinery support
(wanz bar not required)

Flashclad extruded aluminium
Locator

Horizontally fixed Eurobord extruded
aluminium cladding installed by
Flashclad Nationwide Distributor Network

NOTE:
Fixing into studs at maximum
600mm centres

20mm H3.1 vertical cavity batten
with separation layer over

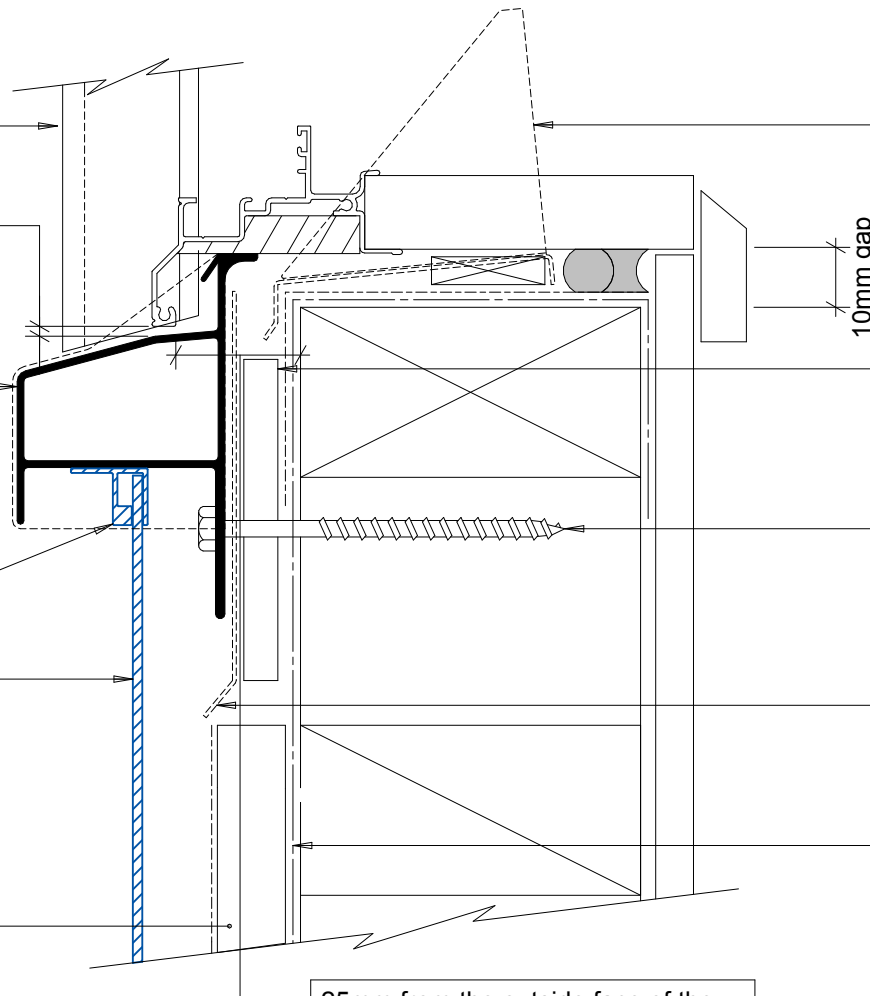

Flashclad aluminium Mitre
Soaker supplied by Flashclad
installed by Builder

10mm gap

H3.1 packer supplied and
installed by Flashclad with
separation layer over

14 gauge hot dip galvanised (316
SS where required) S.T.H.C
screws at 600mm crs. with 65mm
minimum frame penetration.
Supplied and installed by Flashclad

Flashclad Back Plate
(shown dashed)

Building wrap or Rigid Air
Barrier installed as per
manufacturers specification

25mm from the outside face of the
framing (for building wrap detailing)
or 25mm from the outside face of the
Rigid Air Barrier to the back of the
aluminium window or door frame

NOTE:
Aluminium joinery installed with
flashing tape and air seal over
PEF backing rod as per
NZBC E2/AS1



SILL
Original Scale 1:2
Revision - 20 October 2015

Eurobord
HORIZONTAL