

20mm H3.1 cavity batten
with separation layer over

Selected Flashclad extruded aluminium
cladding installed by Flashclad
Nationwide Distributor Network

NOTE:
Attach Locator for vertical cladding
applications

Bevelbord extruded aluminium
Internal Corner

(EXAMPLE)
shadowclad exterior cladding installed
as per manufacturers specification

NOTE:
This detail can be modified to suit:
- Ply
- Cedar
- ACP Panel

NOTE:
Builder to install blocking to suit

H3.1 Packer supplied and
installed by Flashclad

Building wrap or Rigid Air Barrier
installed as per manufacturers
specification

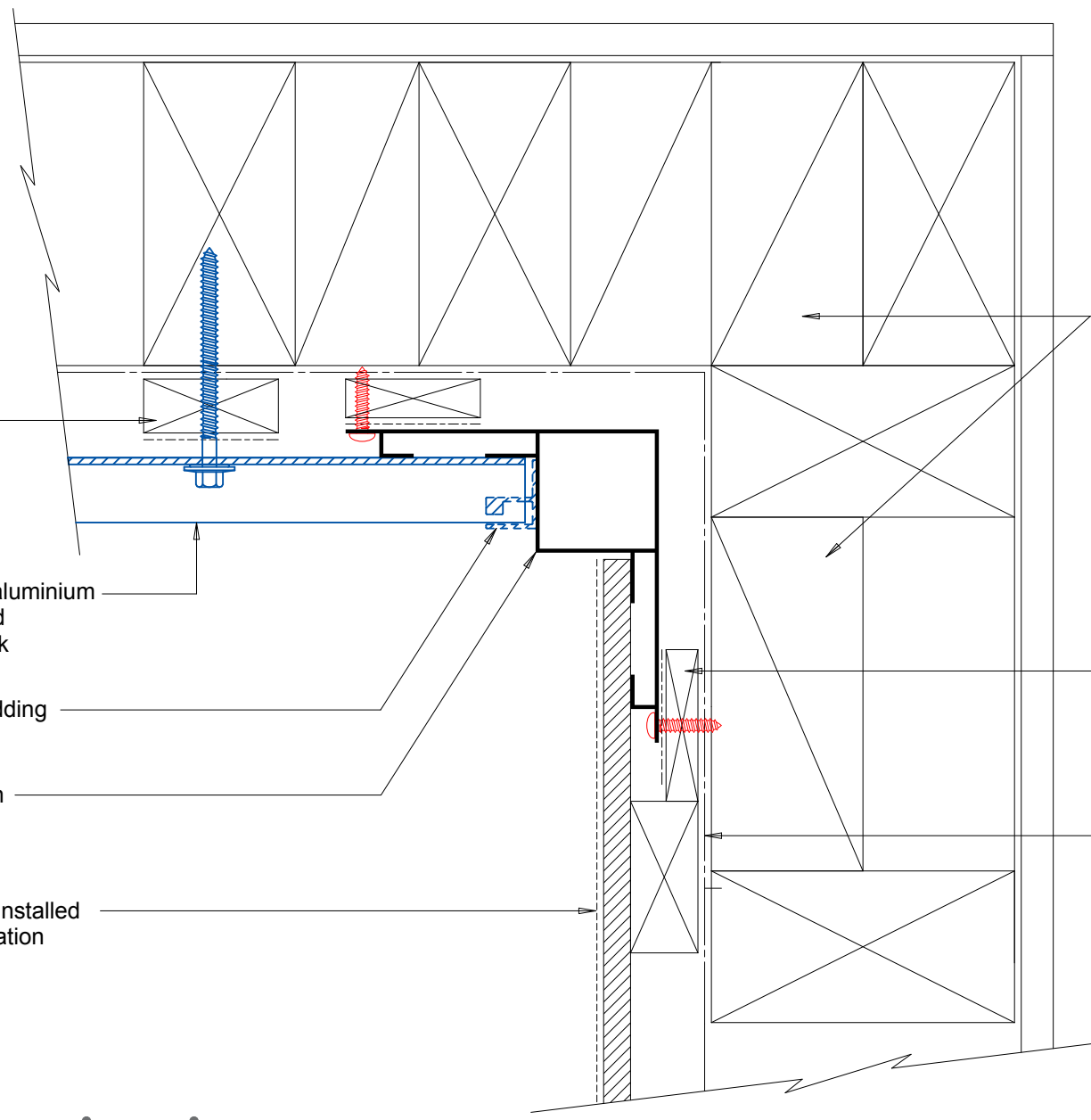

Flashclad
CLADDING FOR LIFE

CLADDING CHANGE INTERNAL CORNER

Original Scale 1:2

Revision - 20 October 2015