

NOTE:  
Do not penetrate  
top surface of capping

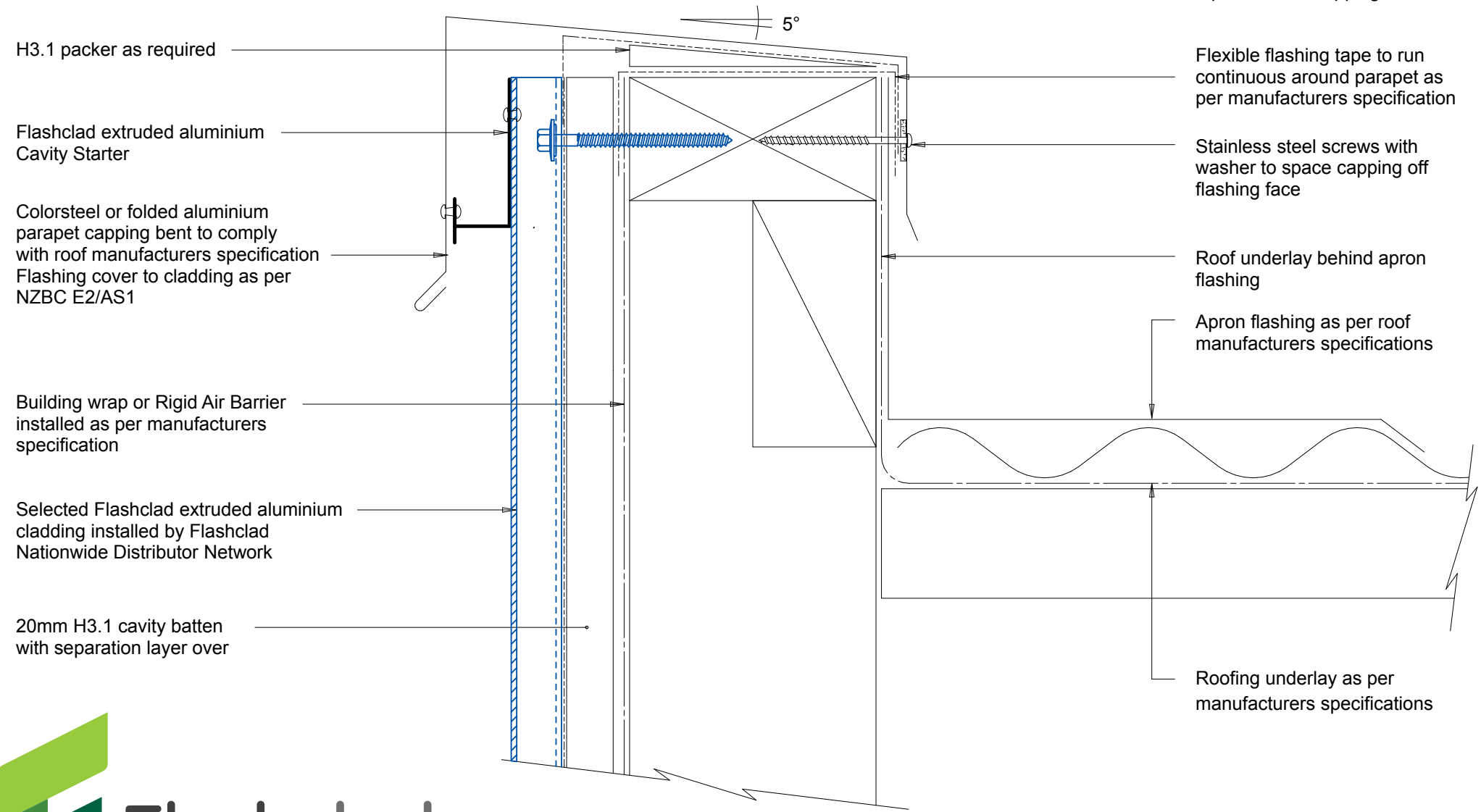

H3.1 packer as required

Flashclad extruded aluminium  
Cavity Starter

Colorsteel or folded aluminium  
parapet capping bent to comply  
with roof manufacturers specification  
Flashing cover to cladding as per  
NZBC E2/AS1

Building wrap or Rigid Air Barrier  
installed as per manufacturers  
specification

Selected Flashclad extruded aluminium  
cladding installed by Flashclad  
Nationwide Distributor Network

20mm H3.1 cavity batten  
with separation layer over

Flexible flashing tape to run  
continuous around parapet as  
per manufacturers specification

Stainless steel screws with  
washer to space capping off  
flashing face

Roof underlay behind apron  
flashing

Apron flashing as per roof  
manufacturers specifications

Roofing underlay as per  
manufacturers specifications



**Flashclad**  
CLADDING FOR LIFE

**PARAPET CAP**  
Original Scale 1:2  
Revision - 20 October 2015