

Vertically fixed Dualbord extruded aluminium cladding installed by Flashclad Nationwide Distributor Network

NOTE:

Dualbord Vertical can be fixed to dwang lines at **600mm or 800mm** centres

Building wrap or Rigid Air Barrier installed as per manufacturers specification

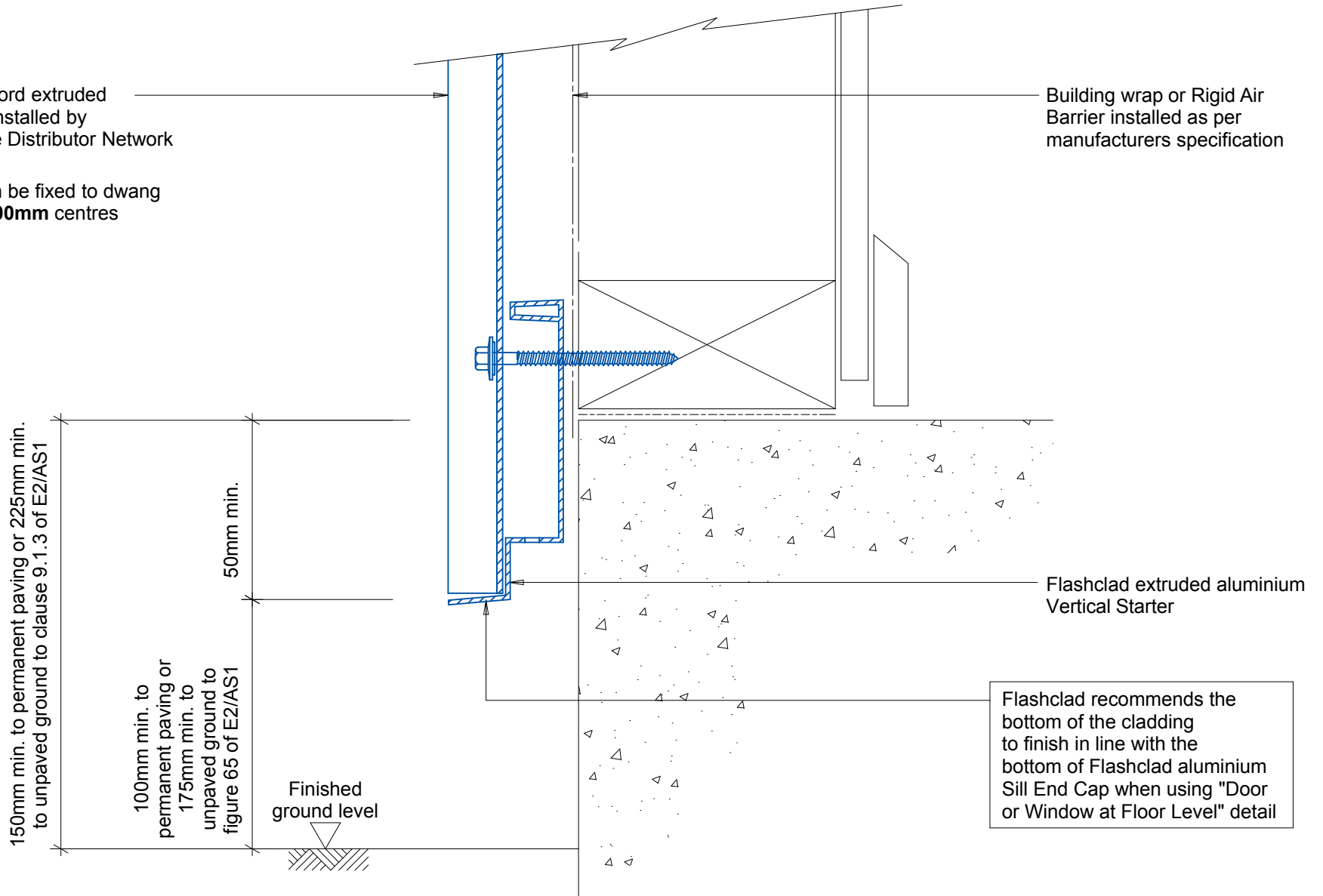

Flashclad
CLADDING FOR LIFE

**BASE STARTER AND
CAVITY CLOSURE**

Original Scale 1:2
Revision - 24 November 2015

Dualbord
VERTICAL