

Flashclad extruded aluminium
2 Part Jamb

Flashclad extruded aluminium
Sill Bead

Bevelbord extruded aluminium
cladding installed by Flashclad
Nationwide Distributor Network
NOTE:
Fixing into studs at maximum
600mm centres

20mm H3.1 vertical cavity batten
with separation layer over

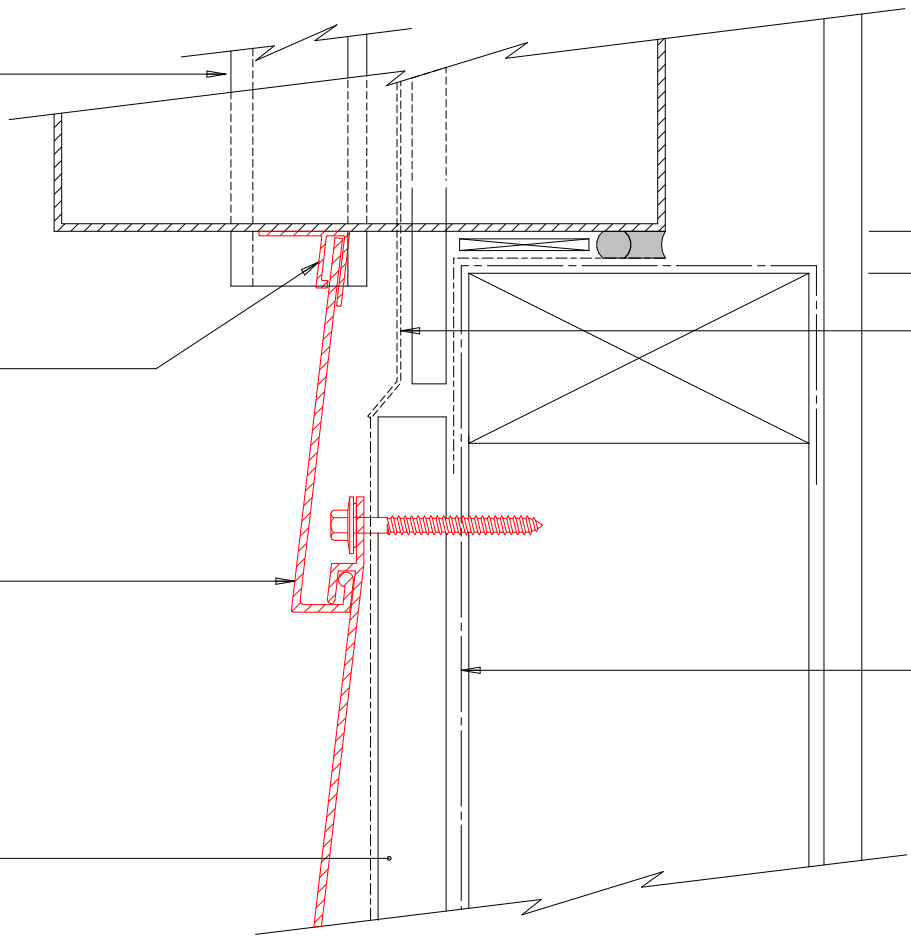

10mm gap

Flashclad Back Plate pack
to behind jamb flashing and
cut to fit around base of
meter box(shown dashed)

Building wrap or Rigid Air
Barrier installed as per
manufacturers specification

NOTE:
Meter box installed with
flashing tape and air seal over
PEF backing rod as per
NZBC E2/AS1



Flashclad
CLADDING FOR LIFE

METER BOX SILL
Original Scale 1:2
Revision - 01 December 2015

Bevelbord