

Bevelbord extruded aluminium cladding installed by Flashclad Nationwide Distributor Network

NOTE:  
Fixing into studs at maximum 600mm centres

20mm H3.1 vertical cavity batten with separation layer over

H3.1 12mm thick 200mm long plywood packers

Flashclad extruded aluminium External Corner

Building wrap or Rigid Air Barrier installed as per manufacturers specification

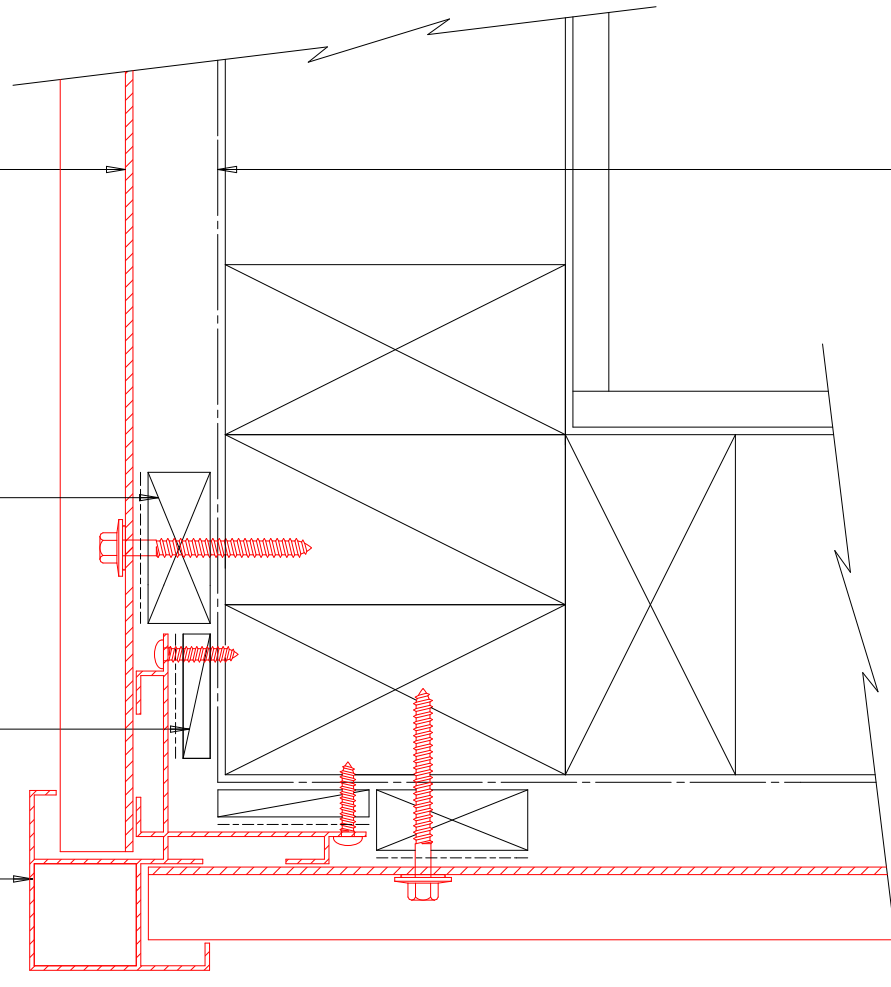

**Flashclad**  
CLADDING FOR LIFE

**EXTERNAL CORNER**

Original Scale 1:2

Revision - 01 December 2015

**Bevelbord**