

NOTE:  
Aluminium joinery installed with  
flashing tape and air seal over  
PEF backing rod as per  
NZBC E2/AS1

Flexible flashing tape to run  
continuous around opening as per  
manufacturers specification

Building wrap or Rigid Air Barrier  
installed as per manufacturers  
specification

H3.1 Packer supplied and  
installed by Flashman

25mm from the outside face of the  
framing (for building wrap detailing) or  
25mm from the outside face of the  
Rigid Air Barrier to the back of the  
aluminium window or door frame

Purpose made 2mm Aluminium  
powder coated Cover Flashing

Flashclad extruded aluminium  
2 Part Jamb

Flashclad extruded aluminium Sill

NOTE:  
Sill provides full joinery support  
(wanz bar not required)

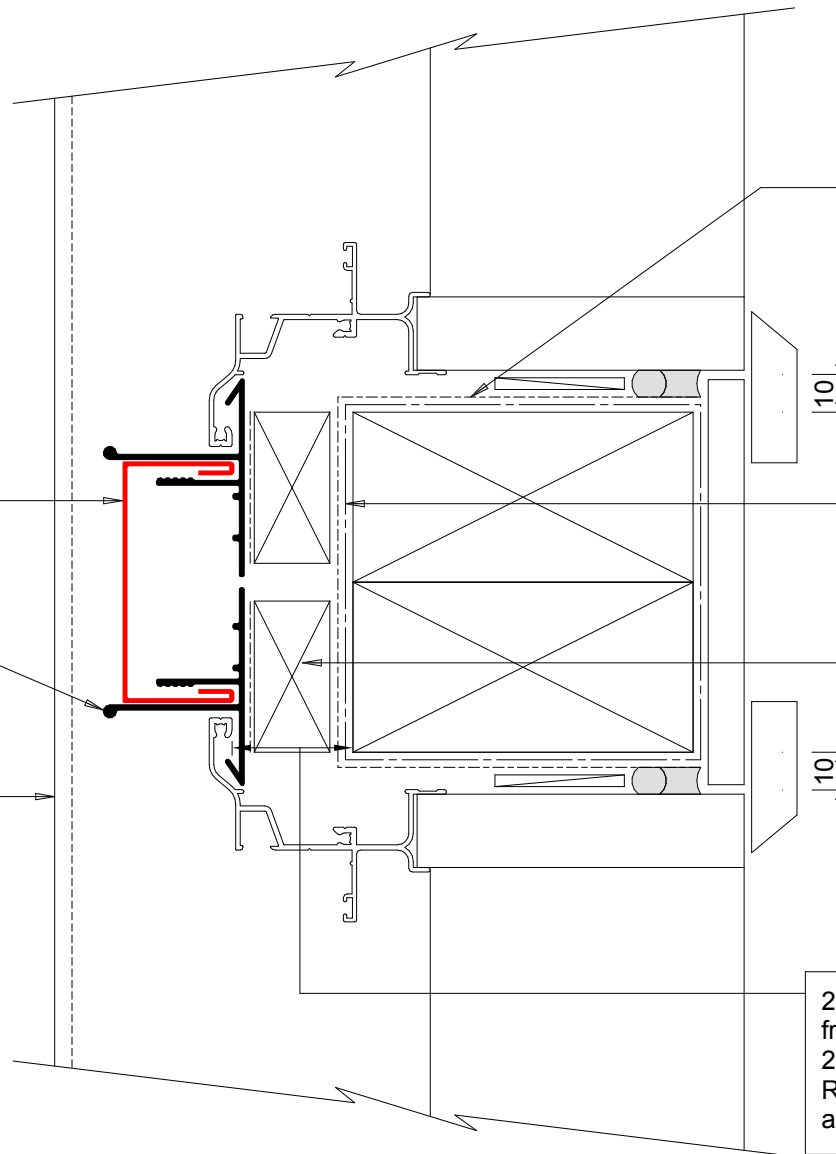

**Flashclad**  
CLADDING FOR LIFE

## JAMB WINDOW TO WINDOW

Original Scale 1:2  
Revision - 20 October 2015

**INFILL PANEL**